



Denison Close | London | N2

£1,998 Per month |

 2  1  1  D

ADN
RESIDENTIAL

A modern and well presented two double bedroom apartment arranged over the first floor of a popular purpose built block located in N2. This wonderful apartment offers well proportioned rooms and comprises, spacious reception room, separate fully fitted kitchen, two double bedrooms, and a modern family bathroom. Additional benefits include communal gardens and wooden flooring.



- Two Bedrooms
- Family Bathroom
- Communal Gardens
- Reception Room
- Permit Parking
- Wooden Flooring



Council Tax Band: D
EPC: D



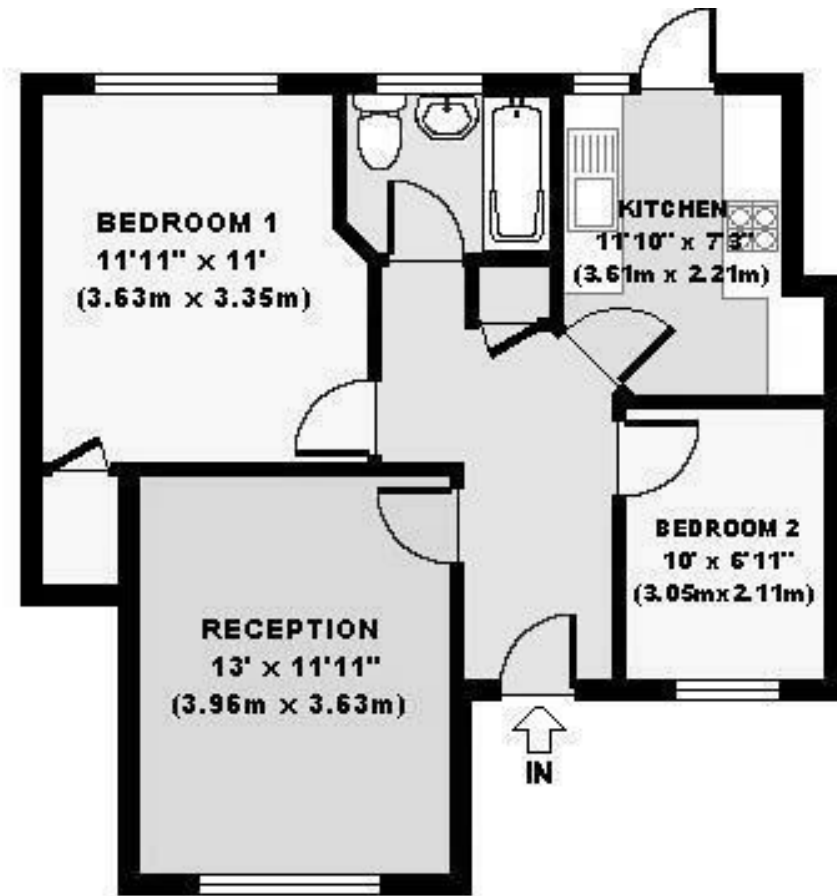

APPROX. GROSS INTERNAL FLOOR AREA 590 SQ FT / 54 SQ M

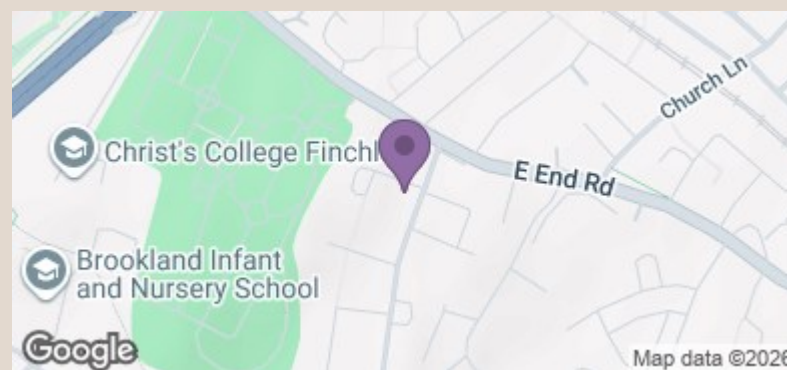

Energy Efficiency Rating		Current	Potential
Very energy efficient - lower running costs			
(92 plus) A			
(81-91) B			
(69-80) C			
(55-68) D		66	78
(39-54) E			
(21-38) F			
(1-20) G			
Not energy efficient - higher running costs			
England & Wales		EU Directive 2002/91/EC	

info@adnresidential.co.uk | 020 7407 5155