



Beechcroft Avenue | London | NW11

£2,100 Per month |

 1  1  1  C

ADN
RESIDENTIAL

A well presented one double bedroom apartment arranged on the ground floor of a popular purpose built block located in the centre of Golders Green. This lovely apartment benefits from having off street parking for one car and communal gardens and comprises, spacious reception room, separate fitted kitchen, double bedroom and a family bathroom. Beechcroft Avenue is ideally located 0.3m from Golders Green underground station.

Council Tax: Barnet – Band E

Security Deposit: £2,420

Holding Deposit: £484.61

Deposits shown are based on an Assured Periodic Tenancy Agreement.

-
- One Bedroom
 - Kitchen
 - Off Street Parking
 - Reception Room
 - Bathroom
 - Communal Gardens
-

Council Tax Band: E
EPC: C





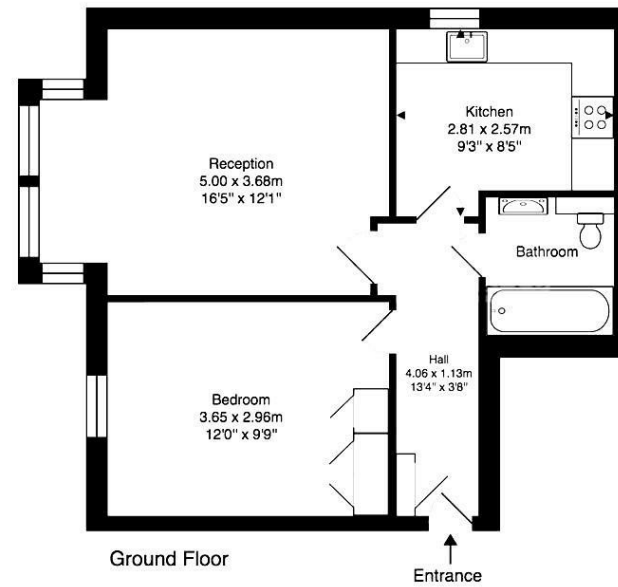

Approx. Gross Internal Area: 44.7 m² ... 482 ft²

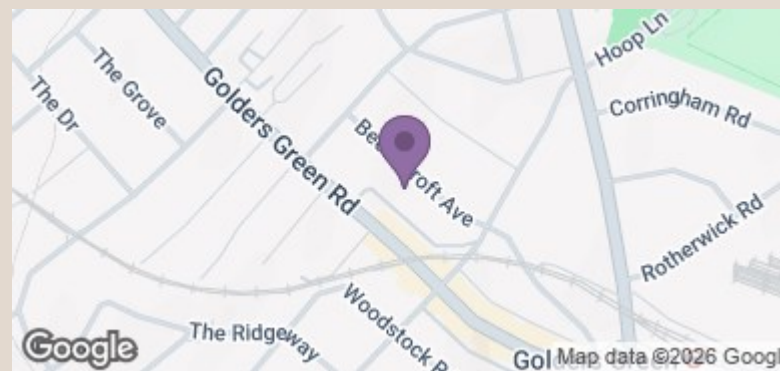

Energy Efficiency Rating		Current	Potential
Very energy efficient - lower running costs			
(92 plus)	A		
(81-91)	B		
(69-80)	C	80	80
(55-68)	D		
(39-54)	E		
(21-38)	F		
(1-20)	G		
Not energy efficient - higher running costs			

England & Wales EU Directive 2002/91/EC