



Lambolle Road | London | NW3

£623 Per Week |



**ADN**  
RESIDENTIAL

A superb two double bedroom apartment arranged over the second floor of a well presented purpose built block located in the heart of Belsize Park. This fantastic property benefits from having a private terrace and comprises, spacious reception room with wooden flooring and access onto the private terrace, separate fully fitted kitchen, principal bedroom with built in storage, second double bedroom with built in storage and a family bathroom. Additional benefits include access to landscaped communal gardens and double glazed windows.

- 2 Double Bedrooms
- Fully Fitted Kitchen
- Terrace
- Reception Room
- Family Bathroom
- Communal Gardens

Council Tax Band: F  
EPC: C





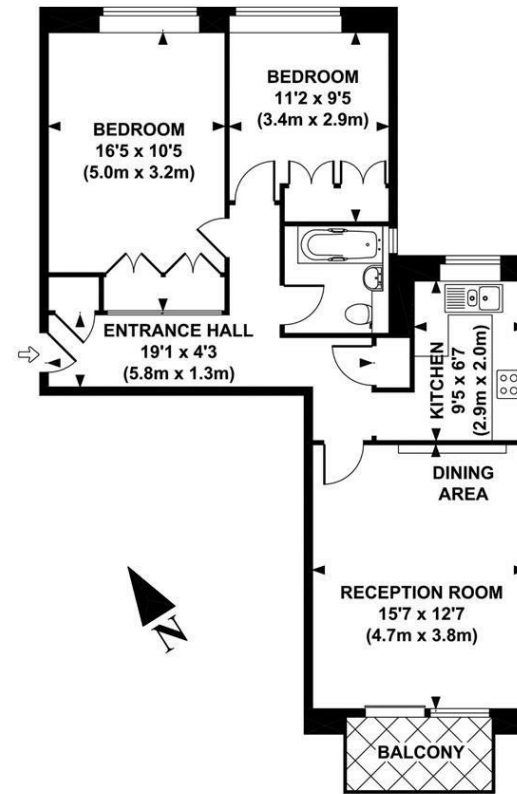

SECOND FLOOR

APPROX. GROSS INTERNAL FLOOR AREA 720 SQ FT / 67 SQ M

This floorplan is for illustration purposes and may not truly reflect design or dimensions and should not be used for valuation or condition purposes .

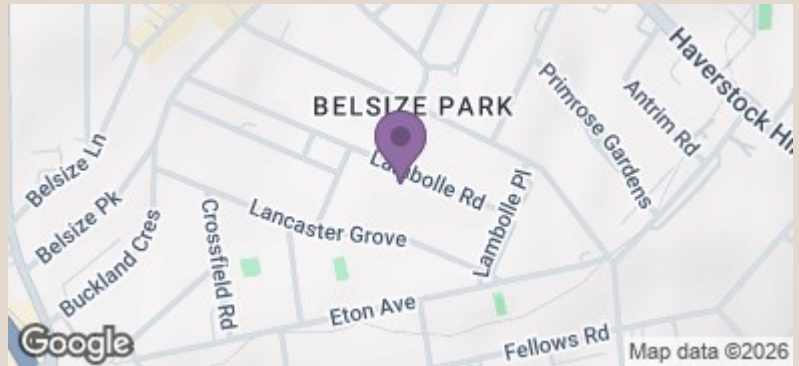

Energy Efficiency Rating		Current	Potential
Very energy efficient - lower running costs			
(92 plus)	A		
(81-91)	B		
(69-80)	C		75
(55-68)	D		
(39-54)	E		
(21-38)	F		
(1-20)	G		
Not energy efficient - higher running costs			
England & Wales		EU Directive 2002/91/EC	