



Lindfield Gardens | London | NW3

£760 Per Week |

 2  1  1  D

ADN
RESIDENTIAL

A modern and recently refurbished two bedroom apartment arranged over the first floor of a well presented period property located in Hampstead NW3. This fantastic property has been finished to the highest of standards and comprises, open plan kitchen reception, two bedrooms with built in storage and a family bathroom. Further benefits include wooden flooring and double glazed windows.

- 2 Bedrooms
- Open Plan Kitchen/Reception Room
- Bathroom
- Recently Refurbished
- Wooden Flooring

Council Tax Band: E
EPC: D





Lindfield Gardens, NW3

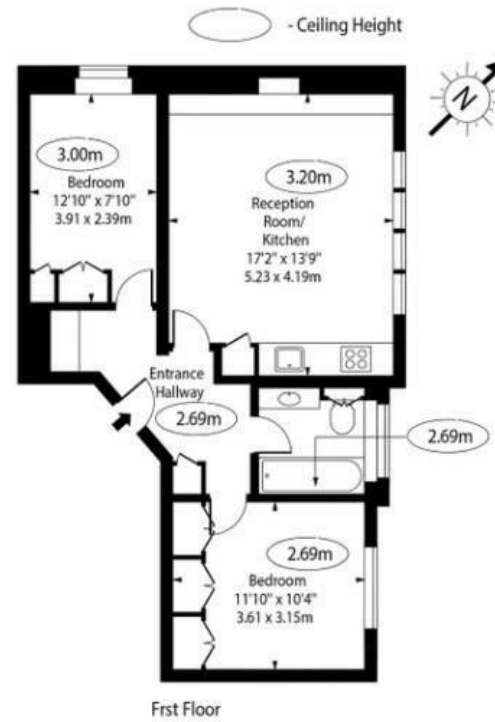

Approx Gross Internal Area 600 Sq Ft - 55.74 Sq M

NOT TO SCALE

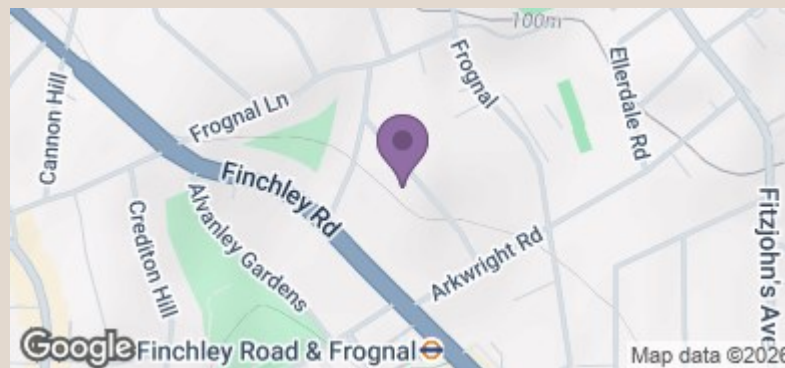

Energy Efficiency Rating		Current	Potential
Very energy efficient - lower running costs			
(92 plus) A			
(81-91) B			
(69-80) C			
(55-68) D		67	80
(39-54) E			
(21-38) F			
(1-20) G			
Not energy efficient - higher running costs			
England & Wales		EU Directive 2002/91/EC	